

3 KEY PLAN

Floor	Tower 1 (A1&A2) (TYPE A)	Tower 2 (A3&A4) (TYPE A)	Tower 3 (A5&A6) (TYPE A)	Tower 4 (B1&B2) (TYPE B)	Tower 5 (C1) (TYPE C)	Tower 6 (C2) (TYPE C)	Tower 7 (C3) (TYPE C)	Tower 8 (C4) (TYPE C)	Tower 9 (C5) (TYPE C)	Bldg F (EWS)	Bldg G (SHOPPING)	
17th Floor												
16th Floor												
15th Floor												
14th Floor												
13th Floor	985.51	985.51	985.51	1124.36	787.55	787.55	787.55	787.55	787.55			
12th Floor	985.51	985.51	985.51	1124.36	787.55	787.55	787.55	787.55	787.55			
11th Floor	985.51	985.51	985.51	1124.36	787.55	787.55	787.55	787.55	787.55			
10th Floor	985.51	985.51	985.51	1124.36	787.55	787.55	787.55	787.55	787.55			
9th Floor	985.51	985.51	985.51	1124.36	787.55	787.55	787.55	787.55	787.55			
8th Floor	985.51	985.51	985.51	1124.36	787.55	787.55	787.55	787.55	787.55			
7th Floor	985.51	985.51	985.51	1124.36	787.55	787.55	787.55	787.55	787.55			
6th Floor	985.51	985.51	985.51	1124.36	787.55	787.55	787.55	787.55	787.55			
5th Floor	985.51	985.51	985.51	1124.36	787.55	787.55	787.55	787.55	787.55			
4th Floor	985.51	985.51	985.51	1124.36	787.55	787.55	787.55	787.55	787.55			
3rd Floor	985.51	985.51	985.51	1124.36	787.55	787.55	787.55	787.55	787.55			
2nd Floor	985.51	985.51	985.51	1124.36	787.55	787.55	787.55	787.55	787.55			
1st Floor	985.51	985.51	985.51	1124.36	787.55	787.55	787.55	787.55	787.55			
Gr Floor	1074.36	1074.36	1074.36	816.62	816.62	816.62	816.62	816.62	816.62			
Serv. Rm.	15.63			31.26								
Total	13876.99	13876.99	13876.99	16383.71	11057.25	11057.25	11057.25	11057.25	11057.25	3115.28	340.81	
Total FAR of all Residential Towers											3115.28	340.81

4 TOWER FAR CALCULATIONS

Building Block	No of Blocks	Description Layout	No of Floors	Height (in mts)	Main no of Apartments	Units of Dom. Serv.	Ground Coverage	Bldg FAR
Tower 1 (A1&A2)	1	Type A	G + 13	41.90	112	14	1055.98	13876.99
Tower 2 (A3&A4)	1	Type A	G + 13	41.90	112	14	1055.98	13876.99
Tower 3 (A5&A6)	1	Type A	G + 13	41.90	112	14	1055.98	13876.99
Tower 4 (B1&B2)	1	Type B	G + 13	41.90	112	28	1180.88	15823.1
Tower 5 (C1)	1	Type C	G + 13	41.90	56	5	821.28	14059.25
Tower 6 (C2)	1	Type C	G + 13	41.90	56	5	821.28	14059.25
Tower 7 (C3)	1	Type C	G + 13	41.90	56	5	821.28	14059.25
Tower 8 (C4)	1	Type C	G + 13	41.90	56	5	821.28	14059.25
Tower 9 (C5)	1	Type C	G + 13	41.90	56	5	821.28	14059.25
Bldg F	1	EWS Housing	G + 3	12.25	-	-	-	-
Bldg G	1	Convenient Shops	G	4.00	-	-	-	-
Bldg H	2	Nursery School	G	4.00	-	-	-	-
Guard room	1	Guard Room	G	4.00	-	-	-	-
Covered ECS @ 25	179	-	-	-	-	-	4475.00	-
LT room	1	-	-	-	-	-	395.62	-
Total Nos.					744	75	14877.47	119224.85

5 TOTAL SITE BLDG. FAR CALCULATIONS

POPULATION DENSITY	Nos	H.H Size	Population
Typical Unit			
Main Dwelling Units	744	5	3720
EWS Dw units	132	2	264
Dom. Serv Units	75	2	150
Total			4134
Proposed Population Density			245.4

CONVENIENT SHOPPING	Area (sqmt)
Permissible max 0.5% of Site area	340.82
Proposed Coverage	340.82
Proposed FAR	340.82

NURSERY SCHOOL (BLDG 'H')	Area (sqmt)
Allotted Site = 0.2 Acres	809.37
Min. Permissible Coverage @ 25%	202.343
Proposed Coverage	202.688

UG. Water Tank and Pump Room	Area (sqmt)
UG. Water Tank and Pump Room	360.00
Filtration Plant and Balancing Tank	25.30
Power Generator Unit + HT & LT Panel room	395.62
Sewage Treatment Plant	245.00
Ground Water Recharge Pits and Bore Wells	-

PARKING CALCULATIONS	Area (sqmt)
Required @ 1.5 ECS on main DU's	1116
Covered ECS required @ 75%	837
Basement Area	
Level 1	12427.33
Level 2	12427.33
Total basement area	24854.66

OPEN SPACE/ORGANISED GREEN	Area (sqmt)
Minimum Open Space @ 15% Site Area	10224.59
Provided Open Space	26301.814
Provided Open Space	38.59%

UG. Water Tank and Pump Room	Area (sqmt)
UG. Water Tank and Pump Room	360.00
Filtration Plant and Balancing Tank	25.30
Power Generator Unit + HT & LT Panel room	395.62
Sewage Treatment Plant	245.00
Ground Water Recharge Pits and Bore Wells	-

6 OVERALL PROJECT PROPOSALS

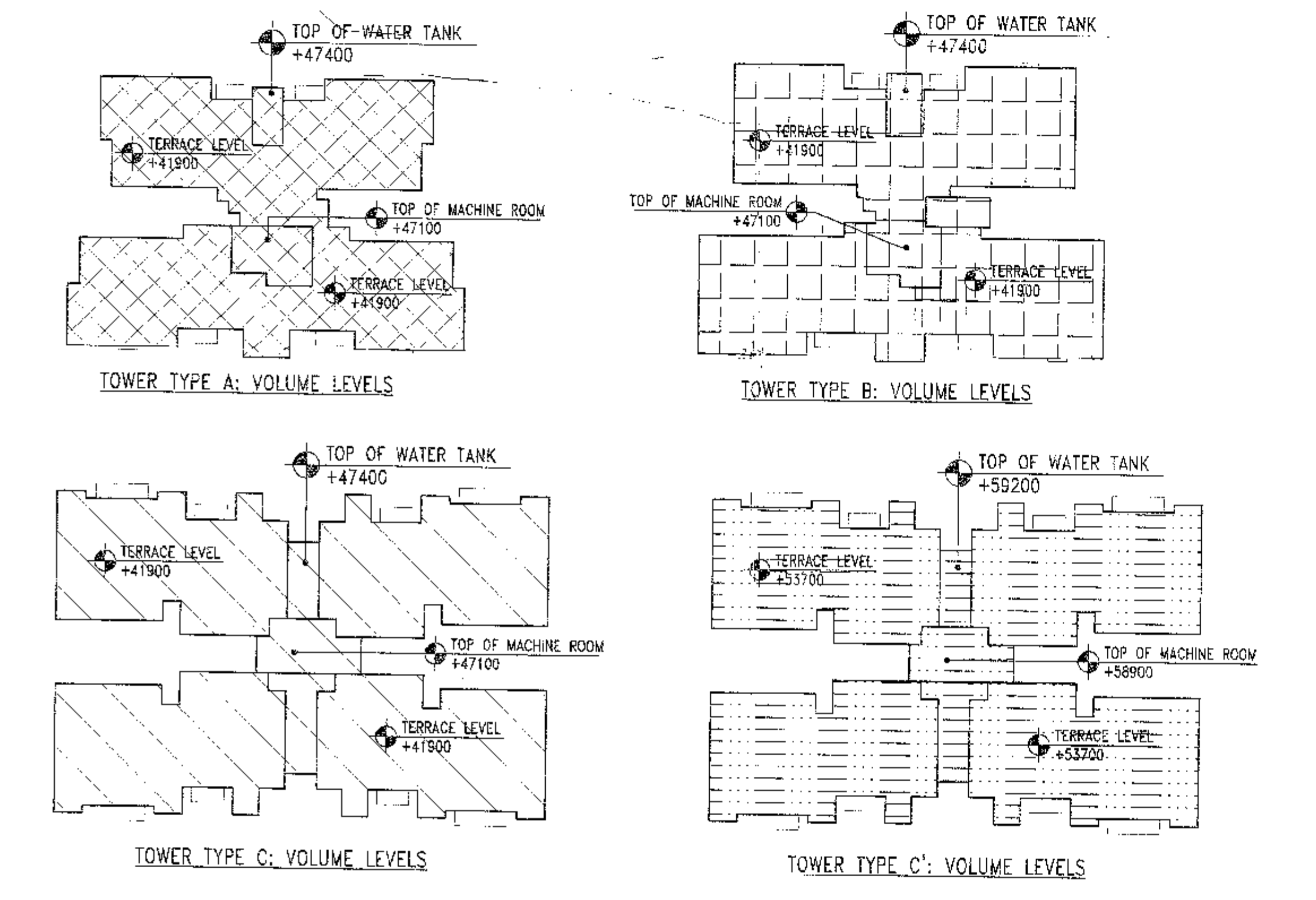

2 TOWER PROFILE

TOWER NAME	BLOCKS	HEIGHT
T1	A1, A2	41900
T2	A3, A4	41900
T3	A5, A6	41900
T4	B1, B2	41900
T5	C1	41900
T6	C2	41900
T7	C3	41900
T8	C4	41900
T9	C5	53700

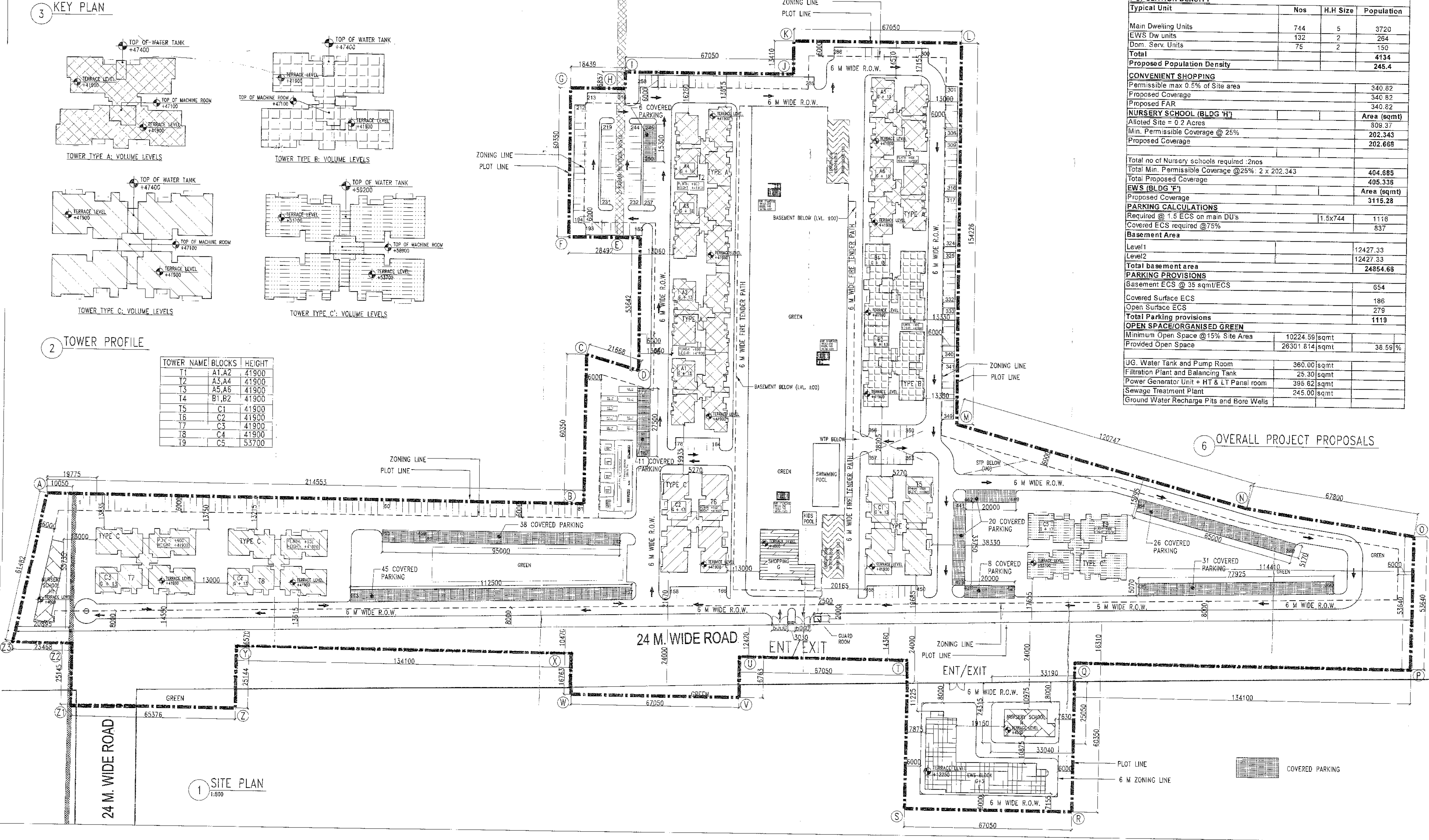

1 SITE PLAN

SERVICES CONSULTANTS PDU DESIGN-MEP

ADDRESS
UNITECH Ltd. Unitech House,
L-Block South City-1
Gurgaon - 122001 - India.
TEL: 4126200 124 +91;
fax: 2383332 124 +91;

NOTE:
1. BASEMENTS ARE FULLY SPRINKLED

UNITECH LIMITED
Project Design Unit
Plot No. 136, 2nd Floor, Gurgaon
Gurgaon-122018, Haryana
Telephone # 91-124-430 6186
Fax No. # 91-124-430 6186

UNITECH LIMITED
Project Design Unit
Plot No. 136, 2nd Floor, Gurgaon
Gurgaon-122018, Haryana
Telephone # 91-124-430 6186
Fax No. # 91-124-430 6186

DATE: 30-JUNE-2010
DRAWING NO. A-001
SHEET NO. 1/58

REVISIONS
NO. DATE DESCRIPTION

UNITECH LIMITED
SUPERINTENDING ENGINEER (H/O)
H/O: Panchsheel

OWNER'S SIGNATURE
For UNITECH LIMITED
(K. K. Mittal)
Authorized Signatory

SCALE: 1:800
PROJECT NO. AU-0013

ARCHITECT'S SIGNATURE
OWNER'S SIGNATURE

DATE: 30-JUNE-2010
DRAWING NO. A-001
SHEET NO. 1/58

UNITECH LIMITED

This drawing is copyright. It is the property of the architect and is not to be reproduced, copied, handed over to a third party or used for any purpose other than for which it has been framed.