

S.P. Singh
 Superintending Engineer (RQ)
 HUDA, Panchkula

[Signature]
 Chief Engineer
 H. Urban Dev. Authority
 Panchkula

[Signature]
 Director
 Town and Country Planning,
 Haryana, Chandigarh

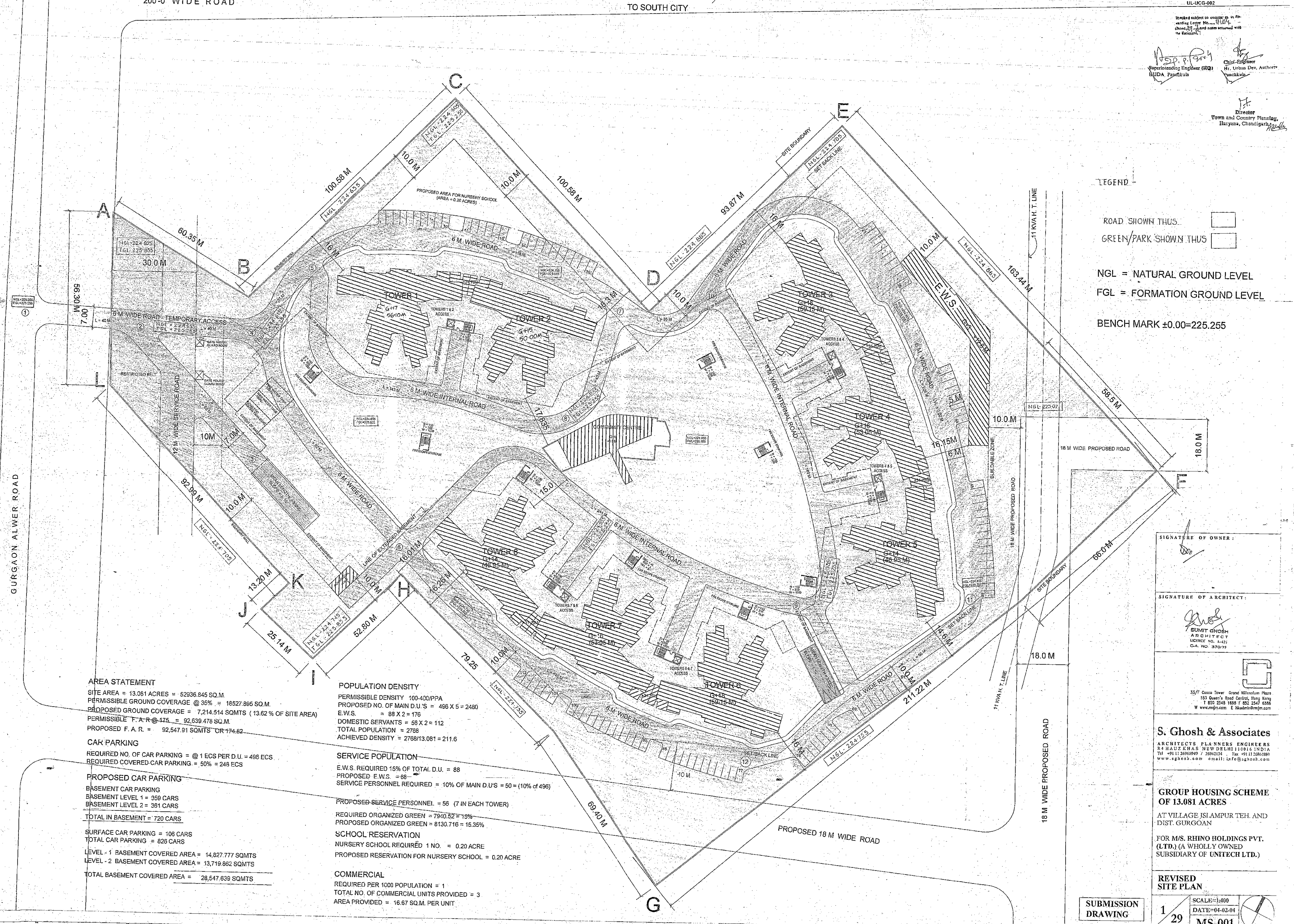

LEGEND

ROAD SHOWN THUS

GREEN/PARK SHOWN THUS

NGL = NATURAL GROUND LEVEL
 FGL = FORMATION GROUND LEVEL

BENCH MARK ±0.00=225.255

AREA STATEMENT
 SITE AREA = 13.081 ACRES = 52936.845 SQ.M.
 PERMISSIBLE GROUND COVERAGE @ 35% = 18527.895 SQ.M.
 PROPOSED GROUND COVERAGE = 7,214.514 SQMTS (13.62% OF SITE AREA)
 PERMISSIBLE F.A.R @ 1.75 = 92,639.478 SQ.M.
 PROPOSED F.A.R = 92,547.91 SQMTS OR 174.82

CAR PARKING
 REQUIRED NO. OF CAR PARKING = @ 1 ECS PER D.U. = 496 ECS
 REQUIRED COVERED CAR PARKING = 50% = 248 ECS

PROPOSED CAR PARKING
 BASEMENT CAR PARKING
 BASEMENT LEVEL 1 = 359 CARS
 BASEMENT LEVEL 2 = 361 CARS
 TOTAL IN BASEMENT = 720 CARS
 SURFACE CAR PARKING = 106 CARS
 TOTAL CAR PARKING = 826 CARS
 LEVEL - 1 BASEMENT COVERED AREA = 14,827.777 SQMTS
 LEVEL - 2 BASEMENT COVERED AREA = 13,719.862 SQMTS
 TOTAL BASEMENT COVERED AREA = 28,547.639 SQMTS

POPULATION DENSITY
 PERMISSIBLE DENSITY 100-400/PPA
 PROPOSED NO. OF MAIN D.U.'S = 496 X 5 = 2480
 E.W.S. = 88 X 2 = 176
 DOMESTIC SERVANTS = 56 X 2 = 112
 TOTAL POPULATION = 2788
 ACHIEVED DENSITY = 2788/13.081 = 211.6

SERVICE POPULATION
 E.W.S. REQUIRED 15% OF TOTAL D.U. = 88
 PROPOSED E.W.S. = 88
 SERVICE PERSONNEL REQUIRED = 10% OF MAIN D.U.'S = 50 (10% OF 496)

PROPOSED SERVICE PERSONNEL = 56 (7 IN EACH TOWER)
 REQUIRED ORGANIZED GREEN = 7940.52 = 15%
 PROPOSED ORGANIZED GREEN = 8130.716 = 15.35%

SCHOOL RESERVATION
 NURSERY SCHOOL REQUIRED 1 NO. = 0.20 ACRE
 PROPOSED RESERVATION FOR NURSERY SCHOOL = 0.20 ACRE

COMMERCIAL
 REQUIRED PER 1000 POPULATION = 1
 TOTAL NO. OF COMMERCIAL UNITS PROVIDED = 3
 AREA PROVIDED = 16.67 SQ.M. PER UNIT

SIGNATURE OF OWNER:

SIGNATURE OF ARCHITECT:

 SUMIT GHOSH
 ARCHITECT
 LICENCE NO. 1442
 C.A. NO. 370/72

35/F Conco Tower Grand Millennium Plaza
 183 Queen's Road Central, Hong Kong
 T 852 2548 1698 F 852 2547 6386
 W www.rmjm.com E hkadmin@rmjm.com

S. Ghosh & Associates
 ARCHITECTS PLANNERS ENGINEERS
 84 HAUZ KHAS NEW DELHI 110016 INDIA
 Tel +91 11 26960049 / 26962134 Fax +91 11 26861880
 www.sghosh.com email: info@sghosh.com

GROUP HOUSING SCHEME OF 13.081 ACRES
 AT VILLAGE JSLAMPUR TEH. AND DIST. GURGOAN
 FOR M/S. RHINO HOLDINGS PVT. (LTD.) (A WHOLLY OWNED SUBSIDIARY OF UNITECH LTD.)

REVISED SITE PLAN

SUBMISSION DRAWING 1/29

SCALE=1:400
 DATE=04-02-04
 MS-001